

P E R M I T

CITY OF NAPOLEON  
255 W. RIVERVIEW AVE  
NAPOLEON, OHIO 43545

DIVISION OF BUILDING & ZONING  
PH (419) 592-4010  
FAX (419) 599-8393

PERMIT NO: 918

DATE ISSUED: 11-20-01

ISSUED BY: SKE

JOB LOCATION: 566 BECKLEE DR

EST. COST: 128000.00

LOT #: 14

SUBDIVISION NAME: VAN HYNING EST

OWNER: BECKS CONSTRUCTION CO  
ADDRESS: 11-622 CO RD M  
CSZ: NAPOLEON, OH 43545  
PHONE: 419-592-8307

AGENT: BECKS CONSTRUCTION C  
ADDRESS: 11-622 CO RD M  
CSZ: NAPOLEON, OH 43545  
PHONE: 419-592-8307

USE TYPE - RESIDENTIAL: X

OTHER:

ZONING INFORMATION

DIST: R-3 LOT DIM: IRR AREA: 22303 FYRD: 25 SYRD: 7 RYRD: 15  
MAX HT: 45 # PKG SPACES: 2 # LOADING SP: MAX LOT COV: 45

BOARD OF ZONING APPEALS:

WORK TYPE - NEW: X REPLMNT: ADD'N: ALTER: REMODEL:

WORK INFORMATION

SIZE - LGTH: 50 WIDTH: 54 STORIES: 1 LIVING AREA SF: 3054  
GARAGE AREA SF: 494 HEIGHT: 18 BLDG VOL DEMO PERMIT:

WORK DESCRIPTION  
NEW HOME

FEE DESCRIPTION

PAID DATE

FEE AMOUNT DUE

BUILDING PERMIT  
ELECTRICAL PERMIT  
PLUMBING PERMIT  
MECHANICAL PERMIT  
WATER TAP PERMIT  
SEWER PERMIT

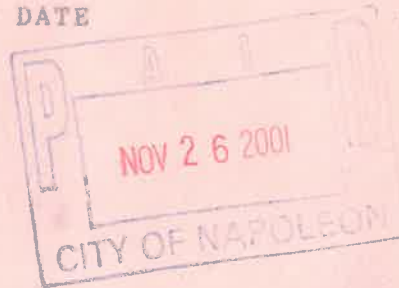

259.00  
109.00  
45.00  
26.00  
655.00  
329.00

TOTAL FEES DUE 1423.00

11/26/01  
DATE

Cheryl A. Beck  
APPLICANT SIGNATURE



**APPLICATION FOR**

Residential, Building, Electrical, Plumbing, Mechanical, and Demolition Permit  
**FROM - The City of Napoleon, Ohio, Building Department**  
 255 West Riverview Avenue; P.O. Box 151; Napoleon, Ohio 43545 - Telephone (419) 592-4010

ENTRY NO. \_\_\_\_\_

PERMIT NO. \_\_\_\_\_ ISSUED \_\_\_\_\_

JOB LOCATION 566 Beckler Dr.

LOT 14 Van Hunning Estates  
 (Subdivision or Legal Description)

ISSUED BY \_\_\_\_\_  
 (Building Official)

OWNER Becks Const. PHONE 592-8307

ADDRESS 11622 Co. Rd. W Napoleon

AGENT " " PHONE \_\_\_\_\_

ADDRESS \_\_\_\_\_

USE:  Residential ( ) Commercial ( ) Industrial  
 ( ) Other \_\_\_\_\_

WORK:  New ( ) Addition ( ) Replacement ( ) Remodel

ESTIMATED COST = \$ 128,000

	<u>Base</u>	<u>Plus</u>	<u>Total</u>
<input checked="" type="checkbox"/> Building	\$ _____	\$ _____	\$ <u>259.00</u>
<input checked="" type="checkbox"/> Electrical	\$ _____	\$ _____	\$ <u>109.00</u>
<input checked="" type="checkbox"/> Plumbing	\$ <u>9.00</u>	\$ <u>36.00</u>	\$ <u>45.00</u>
<input checked="" type="checkbox"/> Mechanical	\$ <u>18.00</u>	\$ <u>8.00</u>	\$ <u>26.00</u>
( ) Demolition	\$ _____	\$ _____	\$ _____
( ) Zoning	\$ _____	\$ _____	\$ _____
( ) Sign	\$ _____	\$ _____	\$ _____
<input checked="" type="checkbox"/> Water Tap	\$ <u>650.00</u>	\$ <u>5.00</u>	\$ <u>655.00</u>
<input checked="" type="checkbox"/> Sewer Tap	\$ <u>269.00</u>	\$ <u>60.00</u>	\$ <u>329.00</u>
( ) Temp Water	\$ _____	\$ _____	\$ _____
( ) Temp Elec.	\$ _____	\$ _____	\$ _____

Additional Plan Review: Structure \_\_\_\_\_ Hours \_\_\_\_\_  
 Electric \_\_\_\_\_ Hours \_\_\_\_\_

TOTAL FEES . . . . . \$ \_\_\_\_\_  
 Less Fees Paid . . . . . \$ \_\_\_\_\_  
 BALANCE DUE . . . . . \$ \_\_\_\_\_

**ZONING INFORMATION**

District	Lot Dimensions	Area	Front Yard	Side Yard	Rear Yard
<u>R-3</u>	<u>150</u>	<u>22303</u>	<u>25</u>	<u>7</u>	<u>15</u>

Max Height	No. Pkg. Spaces	No. Lq. Spaces	Max Cover	Petition or Appeal Required-Date
<u>45'</u>	<u>2</u>		<u>45%</u>	

**WORK INFORMATION**

Building: Ground Floor Area 1726 sq. ft. Basement Floor Area 1328 sq. ft.  
 Garage Floor Area 494 sq. ft. 2nd Floor Area \_\_\_\_\_ sq. ft. Other Porch 23 sq. ft.  
 Size: Length 50 Width 54 Stories 1 Height 18'  
 Building Volume (for Demolition Permit) \_\_\_\_\_ cubic feet  
 Description of Work: New Home:

**ELECTRICAL:** Contractor \_\_\_\_\_ Phone \_\_\_\_\_

Address \_\_\_\_\_ ESTIMATED COST = \$ \_\_\_\_\_

Type of Work: ( )New ( )Service Change ( )Rewiring ( )Add'l Wiring TEMPORARY ELEC. REQUIRED - ( )Yes ( )No

Size of Service \_\_\_\_\_ Underground \_\_\_\_\_ Overhead \_\_\_\_\_ Number of New Circuits \_\_\_\_\_

Description of Work: \_\_\_\_\_

**PLUMBING:** Contractor \_\_\_\_\_ Phone \_\_\_\_\_

Address \_\_\_\_\_ ESTIMATED COST = \$ \_\_\_\_\_

WATER TAP REQUIRED - ( )Yes ( )No Size \_\_\_\_\_ Type of Pipe \_\_\_\_\_ Water Dist. Pipe \_\_\_\_\_

SANITARY SEWER TAP REQUIRED - ( )Yes ( )No Size \_\_\_\_\_ Type of Pipe \_\_\_\_\_ Dr. Waste Vt. Pipe \_\_\_\_\_

STREET SEWER TAP REQUIRED - ( )Yes ( )No Type of Pipe \_\_\_\_\_ STREET TO BE OPENED - ( )Yes ( )No

Main Building Drain Size = \_\_\_\_\_ Main Vent Pipe Size = \_\_\_\_\_

**LIST NUMBER OF PLUMBING FIXTURES BELOW:**

Water Closets = 2 Bathtubs = 2 Showers = 1 Lavatories = 2 Kitchen Sinks = 1 Disposal = 1

Clothes Washer = 1 Floor Drains = 1 Dishwasher = 1 Other \_\_\_\_\_ Total = 12

Description of Work: \_\_\_\_\_

**MECHANICAL:** Contractor \_\_\_\_\_ Phone \_\_\_\_\_

Address \_\_\_\_\_ ESTIMATED COST = \$ \_\_\_\_\_

HEATING SYSTEM - ( )Forced Air ( )Gravity ( )Hot Water ( )Steam ( )Unit Heaters ( )Radiant ( )Baseboard

TYPE OF FUEL - (.)Electric ( )Natural Gas ( )Propane ( )Wood ( )Coal ( )Solar ( )Geothermal Other \_\_\_\_\_

NUMBER OF HEAT ZONES = \_\_\_\_\_ HOT WATER - ( )One (1) Pipe ( )Two (2) Pipes ( )Series Loop

ELECTRIC HEAT - Number of Circuits \_\_\_\_\_ Number of Furnaces \_\_\_\_\_ Number of Hot Air Runs \_\_\_\_\_

Number of Hot Water Radiators \_\_\_\_\_ Total Heat Loss \_\_\_\_\_ Rated Capacity of Furnace/Boiler \_\_\_\_\_

LOCATION OF HEATING UNITS - ( )Crawl Space ( )Floor Level ( )Attic ( )Suspended ( )Roof ( )Outside

Description of Work: \_\_\_\_\_

**DRAWINGS REQUIRED:** All applications must be accompanied by two (2) complete sets of Drawings including Site Plans, Foundation Plans, Floor Plans, Structural Framing Plans, Exterior Elevations, Section and Details, Stair Details, Electrical Layout, Plumbing Isometric, Heating Layout, etc. All Plans shall be drawn to scale, show all existing structure on the Site Plans, and show electric panel and furnace locations.

**READ AND SIGN BELOW:** The undersigned hereby makes application for a Permit for all work described herein and agrees to complete the work in strict accordance with all applicable provisions of the current edition of the C.A.B.O. Building Code, the Napoleon Building and Zoning Codes, the Napoleon Engineering Department Rules and Regulations, Standard Specifications and other pertinent sections of the Napoleon Code of Ordinances.

Signature of Applicant \_\_\_\_\_ Date \_\_\_\_\_

**ELECTRICAL:** Contractor \_\_\_\_\_ Phone \_\_\_\_\_  
Address \_\_\_\_\_ ESTIMATED COST = \$ \_\_\_\_\_  
Type of Work: ( ) New ( ) Service Change ( ) Rewiring ( ) Add'l Wiring TEMPORARY ELEC. REQUIRED - ( ) Yes ( ) No  
Size of Service \_\_\_\_\_ Underground \_\_\_\_\_ Overhead \_\_\_\_\_ Number of New Circuits \_\_\_\_\_

Description of Work: \_\_\_\_\_

**PLUMBING:** Contractor \_\_\_\_\_ Phone \_\_\_\_\_  
Address \_\_\_\_\_ ESTIMATED COST = \$ \_\_\_\_\_

WATER TAP REQUIRED - ( ) Yes ( ) No Size \_\_\_\_\_ Type of Pipe \_\_\_\_\_ Water Dist. Pipe \_\_\_\_\_

SANITARY SEWER TAP REQUIRED - ( ) Yes ( ) No Size \_\_\_\_\_ Type of Pipe \_\_\_\_\_ Dr. Waste Vt. Pipe \_\_\_\_\_

STREET SEWER TAP REQUIRED - ( ) Yes ( ) No Type of Pipe \_\_\_\_\_ STREET TO BE OPENED - ( ) Yes ( ) No

Main Building Drain Size = \_\_\_\_\_ Main Vent Pipe Size = \_\_\_\_\_

**LIST NUMBER OF PLUMBING FIXTURES BELOW:**

Water Closets = 2 Bathtubs = 2 Showers = 1 Lavatories = 2 Kitchen Sinks = 1 Disposal = 1  
Clothes Washer = 1 Floor Drains = 1 Dishwasher = 1 Other \_\_\_\_\_ Total = 12

Description of Work: \_\_\_\_\_

**MECHANICAL:** Contractor \_\_\_\_\_ Phone \_\_\_\_\_  
Address \_\_\_\_\_ ESTIMATED COST = \$ \_\_\_\_\_

HEATING SYSTEM - ( ) Forced Air ( ) Gravity ( ) Hot Water ( ) Steam ( ) Unit Heaters ( ) Radiant ( ) Baseboard

TYPE OF FUEL - ( ) Electric ( ) Natural Gas ( ) Propane ( ) Wood ( ) Coal ( ) Solar ( ) Geothermal Other \_\_\_\_\_

NUMBER OF HEAT ZONES = \_\_\_\_\_ HOT WATER - ( ) One (1) Pipe ( ) Two (2) Pipes ( ) Series Loop

ELECTRIC HEAT - Number of Circuits \_\_\_\_\_ Number of Furnaces \_\_\_\_\_ Number of Hot Air Runs \_\_\_\_\_

Number of Hot Water Radiators \_\_\_\_\_ Total Heat Loss \_\_\_\_\_ Rated Capacity of Furnace/Boiler \_\_\_\_\_

LOCATION OF HEATING UNITS - ( ) Crawl Space ( ) Floor Level ( ) Attic ( ) Suspended ( ) Roof ( ) Outside

Description of Work: \_\_\_\_\_

**DRAWINGS REQUIRED:** All applications must be accompanied by two (2) complete sets of Drawings including Site Plans, Foundation Plans, Floor Plans, Structural Framing Plans, Exterior Elevations, Section and Details, Stair Details, Electrical Layout, Plumbing Isometric, Heating Layout, etc. All Plans shall be drawn to scale, show all existing structure on the Site Plans, and show electric panel and furnace locations.

**READ AND SIGN BELOW:** The undersigned hereby makes application for a Permit for all work described herein and agrees to complete the work in strict accordance with all applicable provisions of the current edition of the C.A.B.O. Building Code, the Napoleon Building and Zoning Codes, the Napoleon Engineering Department Rules and Regulations, Standard Specifications and other pertinent sections of the Napoleon Code of Ordinances.

Signature of Applicant \_\_\_\_\_ Date \_\_\_\_\_





# City of NAPOLEON, OHIO

255 WEST RIVERVIEW AVENUE, P.O. BOX 151  
NAPOLEON, OHIO 43545-0151  
(419) 592-4010  
FAX (419) 599-8393

## Fax Transmission

Mayor  
J. Andrew Small

Members of Council  
Michael J. DeWit, President  
Terri A. Williams  
James Hershberger  
Travis B. Sheaffer  
John A. Helberg  
Jean A. Steele  
Glenn A. Miller

City Manager  
Dr. Jon A. Bisher

Finance Director  
Gregory J. Heath

Law Director  
David M. Grahn

City Engineer  
Joseph R. Kleiner, P.E.

To: \_\_\_\_\_

Company Name: Becks Construction Co.

Fax Number: 419-592-4563

Number of Pages (Including Cover Page): 3

From: Brent N. Dammar

Date: 11/21/01 Time: ~~1:35pm~~ 1:50pm

Operator: Sandy Eberle

Comments:

New Homes - 566 Becklee Dr.  
605 Cambridge St.

Copy of permit fees for each location  
to follow.

Thank you!

*Please call (419) 592-4010 if you have any trouble receiving this Transmission or you did not receive the number of pages shown above.*





P E R M I T

CITY OF NAPOLEON  
255 W. RIVERVIEW AVE  
NAPOLEON, OHIO 43545

DIVISION OF BUILDING & ZONING  
PH (419) 592-4010  
FAX (419) 599-8393

PERMIT NO: 918                      DATE ISSUED: 11-20-01              ISSUED BY: SKE  
JOB LOCATION: 566 BECKLEE DR                      EST. COST: 128000.00  
LOT #: 14                                      SUBDIVISION NAME: VAN HYNING EST

OWNER: BECKS CONSTRUCTION CO                      AGENT: BECKS CONSTRUCTION C  
ADDRESS: 11-622 CO RD M                      ADDRESS: 11-622 CO RD M  
CSZ: NAPOLEON, OH 43545                      CSZ: NAPOLEON, OH 43545  
PHONE: 419-592-8307                      PHONE: 419-592-8307

USE TYPE - RESIDENTIAL: X                      OTHER:

ZONING INFORMATION

DIST: R-3      LOT DIM: IRR      AREA: 22303 FYRD: 25      SYRD: 7      RYRD: 15  
MAX HT: 45      # PKG SPACES: 2      # LOADING SP:      MAX LOT COV: 45

BOARD OF ZONING APPEALS:

WORK TYPE - NEW: X      REPLMNT:      ADD'N:      ALTER:      REMODEL:

WORK INFORMATION

SIZE - LGTH: 50      WIDTH: 54      STORIES: 1      LIVING AREA SF:      3054  
GARAGE AREA SF: 494      HEIGHT: 18      BLDG VOL DEMO PERMIT:

WORK DESCRIPTION  
NEW HOME

FEE DESCRIPTION	PAID DATE	FEE AMOUNT DUE
BUILDING PERMIT		259.00
ELECTRICAL PERMIT		109.00
PLUMBING PERMIT		45.00
MECHANICAL PERMIT		26.00
WATER TAP PERMIT		655.00
SEWER PERMIT		329.00
TOTAL FEES DUE		1423.00

-----  
DATE

-----  
APPLICANT SIGNATURE



CITY OF NAPOLEON INSPECTION FORM

PERMIT #: 918

DATE ISSUED: 11-20-2001

JOB LOCATION: 566 BECKLEE DR

OWNER: BECKS CONSTRUCTION CO

OWNER PHONE: 419-592-8307

CONTRACTOR: BECKS CONSTRUCTION CO

CONTRACTOR PHONE: 419-592-8307

WORK DESCRIPTION: NEW HOME

PLUMBING: UNDGR 11-27-01 RGHIN 3-20-02 FINAL \_\_\_\_\_

SEWER INSP \_\_\_\_\_

MECHANICAL: UNDGR \_\_\_\_\_ RGHIN \_\_\_\_\_ FINAL \_\_\_\_\_

FURNACE REPLC \_\_\_\_\_ AIR COND \_\_\_\_\_

ELECTRICAL: UNDGR \_\_\_\_\_ RGHIN 3-27-02 FINAL \_\_\_\_\_

SERV UPGR \_\_\_\_\_

BUILDING: SITE 11-20-01 FTG 11-20-01 FNDDT 11-26-01

STRUC \_\_\_\_\_ ROOF \_\_\_\_\_ EXT \_\_\_\_\_

VENT \_\_\_\_\_ ACCES \_\_\_\_\_ EGRS \_\_\_\_\_

SMKDT \_\_\_\_\_ FINAL \_\_\_\_\_

ISSUE TEMP OCCUP \_\_\_\_\_ ISSUE OCCUP 2-10-03

STRG SHED: SITE \_\_\_\_\_ FINAL \_\_\_\_\_

SIGN: FTG \_\_\_\_\_ FINAL \_\_\_\_\_

FENCE: SITE \_\_\_\_\_ FINAL \_\_\_\_\_

MISC INSP: \_\_\_\_\_

NOTES: \_\_\_\_\_

\_\_\_\_\_

\_\_\_\_\_

INSPECTOR INITIALS: \_\_\_\_\_

1917-1918

1917-1918

1917-1918

1917-1918

1917-1918

1917-1918

1917-1918

1917-1918

1917-1918

1917-1918

1917-1918

1917-1918

1917-1918

1917-1918

1917-1918

1917-1918

1917-1918

1917-1918

1917-1918

1917-1918

1917-1918

1917-1918

1917-1918

1917-1918

1917-1918

1917-1918

1917-1918

1917-1918

1917-1918

WATER TAPPING PERMIT  
issued by  
The Napoleon Water Distribution Department  
255 West Riverview Ave. Napoleon, Ohio 43545 Ph. 592-4010

Permit No. W-0251 Issued \_\_\_\_\_ Received of \_\_\_\_\_ (\$ \_\_\_\_\_).00

(Charge for tapping permit to supply water service to) Lot No. \_\_\_\_\_ Sub Div. \_\_\_\_\_

Street No. \_\_\_\_\_ Tap Size \_\_\_\_\_ " Cost \$ \_\_\_\_\_ .00 Plumber \_\_\_\_\_

Date completed \_\_\_\_\_ Approved by Jeffrey E. Montague  
water distribution dept. finance director

Name Lot #14 Size of tap 1" Date 5-14-96 Street and No. 566 Becklee

Old Tap No. — New Tap No. 9638 Size and Kind of Main 8" C-900

Location of Main 8' West of West CURB Depth of Main 5'

Distance from Hydrant/Valve 31' North of Valve Distance to Curb Stop from Corp. 41'

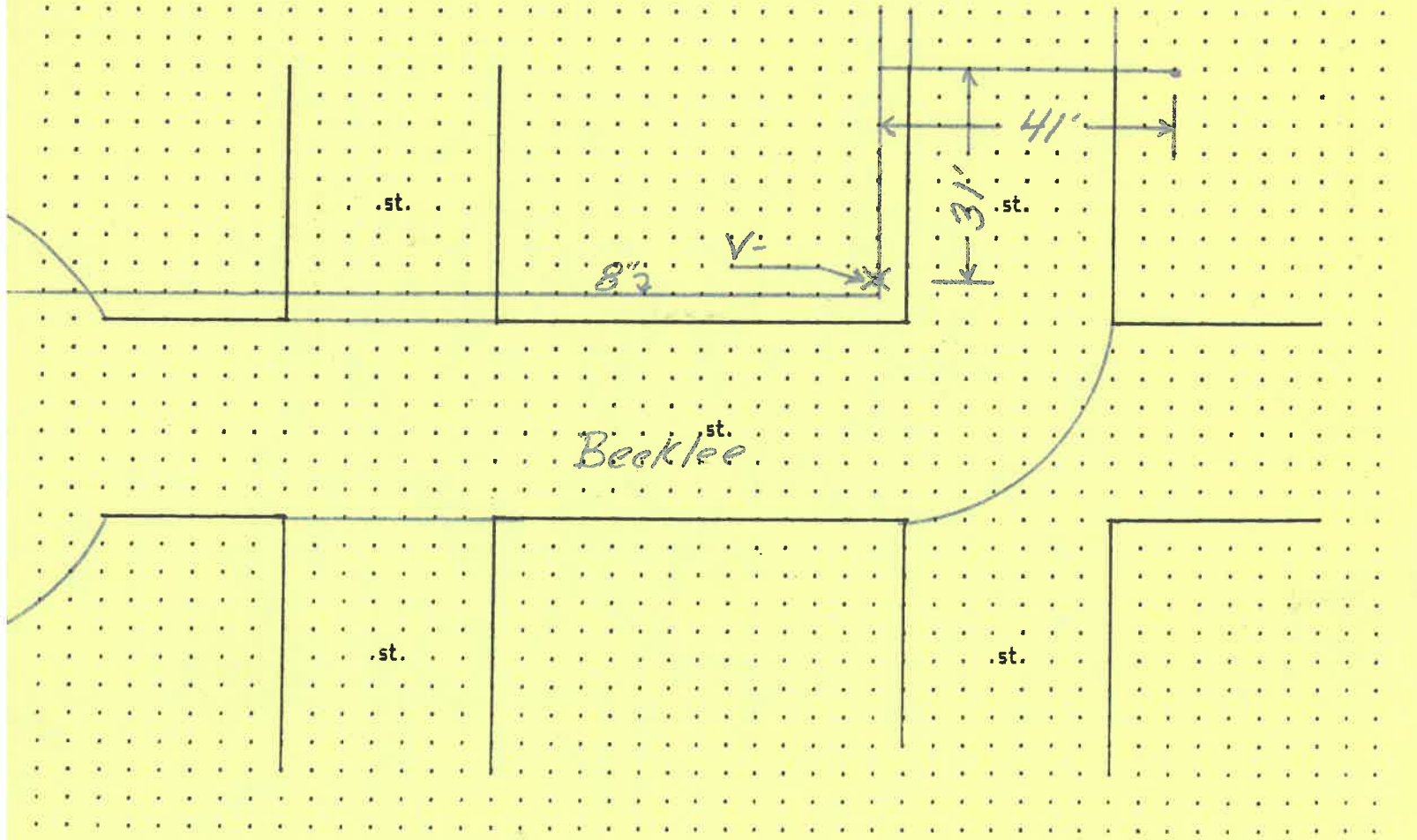



WATER TAPPING PERMIT  
 issued by  
 The Napoleon Water Distribution Department  
 255 West Riverview Ave. Napoleon, Ohio 43545 Ph. 592-4010

Permit No. W- 0251 Issued \_\_\_\_\_ Received of \_\_\_\_\_ (\$ \_\_\_\_\_).00

(Charge for tapping permit to supply water service to) Lot No. \_\_\_\_\_ Sub Div. \_\_\_\_\_

Street No. \_\_\_\_\_ Tap Size \_\_\_\_\_ \* Cost \$ \_\_\_\_\_ .00 Plumber \_\_\_\_\_

Date completed \_\_\_\_\_ Approved by [Signature] water distribution dept. \_\_\_\_\_ finance director

Name Lot #14 Size of tap 1" Date 5-14-96 Street and No. 566 Becklee

Old Tap No. — New Tap No. 9638 Size and Kind of Main 8" C-900

Location of Main 8' West of West curb Depth of Main 5'

Distance from Hydrant/Valve 31' North of Valve Distance to Curb Stop from Corp. 41'

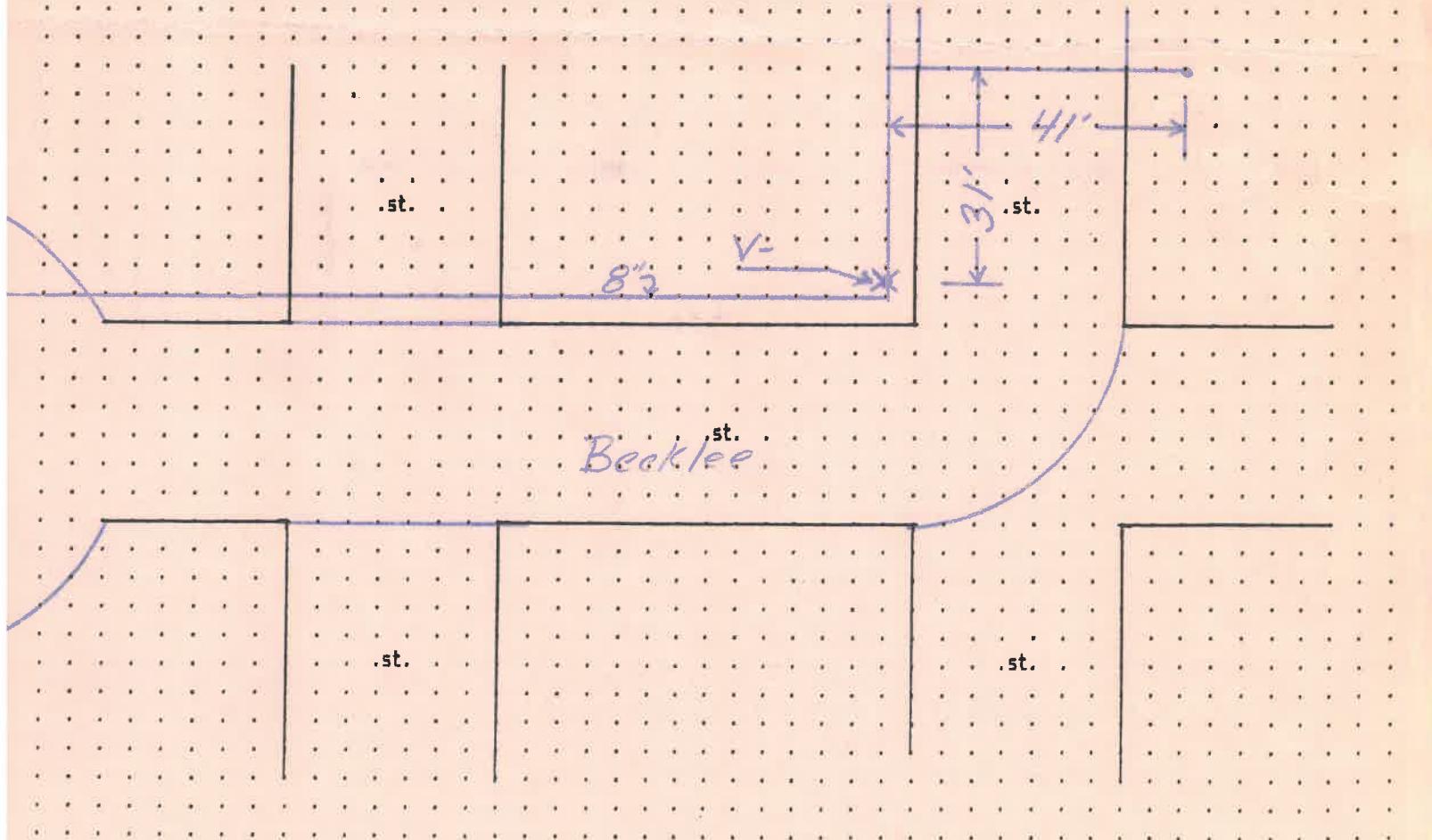





CITY OF NAPOLEON WATER TAPPING PERMIT FORM

PERMIT #: 918

ISSUED: 11-20-2001

JOB LOCATION: 566 BECKLEE DR

SUBDIVISION NAME: Van Hyning Estates LOT #: 14

OWNER: BECKS CONSTRUCTION CO

ADDRESS: 11-622 CO RD M NAPOLEON, OH 43545

CONTRACTOR: BECKS CONSTRUCTION CO PHONE: 419-592-8307

TAP SIZE: 1"  1.5" \_\_\_\_\_ 2" \_\_\_\_\_ OTHER \_\_\_\_\_

AMOUNT PAID: 650.00 YOKE SIZE: 5/8"

PLUMBING CONTRACTOR: Dave Clapp PH: \_\_\_\_\_

=====

DATE OF TAP: \_\_\_\_\_ OLD TAP #: \_\_\_\_\_ NEW TAP #: \_\_\_\_\_

SIZE AND KIND OF MAIN: \_\_\_\_\_

LOCATION OF MAIN: \_\_\_\_\_ DEPTH OF MAIN: \_\_\_\_\_

DIST FROM HYDRANT\VALVE: \_\_\_\_\_ DIST TO CURB STOP FROM CORP: \_\_\_\_\_

.....	.....	.....	.....
.....	.....	.....	.....
.....	.....	.....	.....
.....	.....	.....	.....
.....	.....	.....	.....
.....	.....	.....	.....
.....	.....	.....	.....
.....	.....	.....	.....
.....	.....	.....	.....
.....	.....	.....	.....

.....	.....	.....	.....
.....	.....	.....	.....
.....	.....	.....	.....
.....	.....	.....	.....
.....	.....	.....	.....
.....	.....	.....	.....
.....	.....	.....	.....
.....	.....	.....	.....
.....	.....	.....	.....
.....	.....	.....	.....

.....	.....	.....	.....
.....	.....	.....	.....
.....	.....	.....	.....
.....	.....	.....	.....
.....	.....	.....	.....
.....	.....	.....	.....
.....	.....	.....	.....
.....	.....	.....	.....
.....	.....	.....	.....
.....	.....	.....	.....

DATE APPROVED: \_\_\_\_\_ BY: \_\_\_\_\_



CITY OF NAPOLEON

WATER METER YOKE RELEASE FORM

THIS DOCUMENT ENTITLES THE HOLDER TO "ONE" WATER METER YOKE ASSEMBLY  
(Please pickup at City Operations Department 1775 Industrial Drive).

PERMIT #: 918

ISSUED: 11-20-2001

JOB LOCATION: 566 BECKLEE DR

OWNER: BECKS CONSTRUCTION CO

PHONE: 419-592-8307

ADDRESS: 11-622 CO RD M NAPOLEON, OH 43545

-----  
CONTRACTOR: BECKS CONSTRUCTION CO

ADDRESS: 11-622 CO RD M NAPOLEON, OH 43545

PHONE: 419-592-8307

WATER TAP SIZE 1"  1.5" \_\_\_\_\_ 2" \_\_\_\_\_ OTHER \_\_\_\_\_

WATER METER YOKE SIZE 5/8"  3/4" \_\_\_\_\_ 1" \_\_\_\_\_ OTHER \_\_\_\_\_

NEW STRUCTURE  EXISTING STRUCTURE \_\_\_\_\_ LAWN METER \_\_\_\_\_

WATER SERVICE LINE TO BE TYPE "K" COPPER OR "CTS" POLYETHELENE TUBING  
OF 1" MINIMUM SIZE.

BACKFLOW DEVICE REQUIRED YES  NO \_\_\_\_\_

TYPE OF BACKFLOW DEVICE REQUIRED DCVA

-----  
WATER METER YOKE INSTALLATION IS SUBJECT TO THE FOLLOWING CONDITIONS

- 1.) MUST BE LOCATED IN AN ACCESSIBLE AREA.
- 2.) MUST BE IN AN AREA WHICH IS NOT SUBJECT TO FREEZING TEMPERATURES.
- 3.) MUST BE AT LEAST 18" ABOVE FLOOR LEVEL (NO CRAWL SPACE INSTALLATIONS).
- 4.) MUST COMPLY WITH MINIMUM MOUNTING REQUIREMENTS (DRAWING AVAILABLE)

ISSUED BY \_\_\_\_\_ RECEIVED BY \_\_\_\_\_

1-Copy to: Building Dept, Water Dept, and Utilities Dept



CITY OF NAPOLEON

ELECTRIC METER BASE RELEASE FORM

THIS DOCUMENT ENTITLES THE HOLDER TO "ONE" ELECTRIC METER BASE  
(Please pickup at the City operations garage 1775 Industrial Drive).

PERMIT #: 918

ISSUED: 11-20-2001

JOB LOCATION: 566 BECKLEE DR

WORK DESCRIPTION: NEW HOME

OWNER: BECKS CONSTRUCTION CO

ADDRESS: 11-622 CO RD M NAPOLEON, OH 43545

OWNER PHONE: 419-592-8307

-----  
CONTRACTOR: BECKS CONSTRUCTION CO

ADDRESS: 11-622 CO RD M NAPOLEON, OH 43545

CONTRACTOR PHONE: 419-592-8307

ELECTRIC SERVICE UPGRADE \_\_\_\_\_ NEW SERVICE INSTALLATION X

INDUSTRIAL \_\_\_\_\_ COMMERCIAL \_\_\_\_\_ RESIDENTIAL X 1PHASE X 3PHASE \_\_\_\_\_

SIZE OF SERVICE 100AMP \_\_\_\_\_ 150AMP \_\_\_\_\_ 200AMP X 400AMP \_\_\_\_\_ OTHER \_\_\_\_\_

HUB SIZE - 1 1/4" \_\_\_\_\_ 1 1/2" \_\_\_\_\_ 2" \_\_\_\_\_

DESIRED VOLTAGE 120/240 X OTHER \_\_\_\_\_

UNDERGROUND SERVICE X OVERHEAD SERVICE \_\_\_\_\_

=====

DATE COMPLETED: \_\_\_\_\_ APPROVED BY: \_\_\_\_\_

OLD METER NUMBER: \_\_\_\_\_ NEW METER NUMBER: \_\_\_\_\_

COMMENTS:  
\_\_\_\_\_  
\_\_\_\_\_  
\_\_\_\_\_

